

Single bossed clamps JUNIOR

two-piece, galvanised

Field of application

- Suitable for pipe attachments in industrial areas
- Suitable for fastening of drinking water and heating pipes
- For indoor use

Advantages

- Proven two-piece clamp
- High stiffness due to reinforcing bead
- The 2 locking screws allow adjustment to accommodate a greater variation in pipe diameter

- Tightening bolts with combination cross-head convenient for power driver
- Fastener screws with captive washer
- Connecting thread with combi thread M8/M10
- DÄMMGULAST® Vibration control lining with green identification stripe: average sound level improvement of up to 18 dB(A)
- Vibration control tested



Features



Size	Max. recommended load [N]
12 mm–½"	700
¾"–2"	1,200
70 mm–3"	2,000
102 mm–6"	2,500

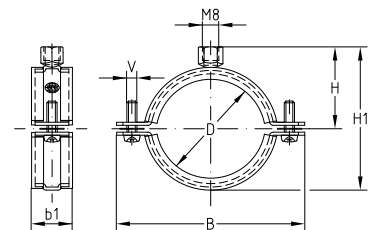

Connecting thread	Size		Clamping range [mm]	Part no.	Sales unit	Pack unit	Dimensions [mm]				
	[inch]	[mm]					B	b1	H1	H	V
M8/M10	¾"	12	12–15	142357	100	pieces	45	22.5	38	28	M5
		15–19	142358	51			44		30		
		20–25	142359	57			50		33		
		25–30	142360	63			56		37		
		33–37	142361	70			64		40		
		42–46	142362	80			72		45		
	1"	47–52	142363	86	79		48				
		54–58	142364	91	84		50				
		59–63	142365	96	88		53				
		68–73	142366	118	104		60	M6			
		72–80	142367	127	113		65				
		82–85	142368	132	119		68				
	88–92	142369	139	125	71						
	99–103	142370	151	137	77						
	108–112	142371	160	145	81						
	1½"	112–118	142372	164	149		83				
		125–130	142373	174	159		88				
		133–137	142374	182	167		92				
137–142		142375	191	175	96						
159–164		142376	210	195	106						
164–169		142377	216	201	109						

	Connecting thread	Size [inch]	Part no.	Sales unit	Pack unit	Content [clamps]	Part no. Polybox excl. clamps	Type
Single bossed clamps JUNIOR, with DÄMMGULAST® green, in polybox	M8/M10	¾"	143958	1	box	200	121019	Polybox large 500/450 x 300 x 180
		½"	143959					
		¾"	143960					
		1"	143961					